

The  
**Official TOWN OF DUNN NEWSLETTER** Spring 2004  
**Smart Growth Planning Continues**

By Renée Lauber,  
 Land Use Manager

As reported in the last newsletter (April 2003), the town has started the state mandated comprehensive planning process

(also called Smart Growth) to update our Land Use Plan. We are still in the information gathering stage and have conducted focus groups with farmers, business owners, lake/river residents, small lot/subdivision/mobile home residents, and new lake residents (people that moved to lake within the last 3-4 years). A summary of these group discussions can be found on the town's webpage at [www.town.dunn.wi.us](http://www.town.dunn.wi.us).

We also mailed a land use survey to all town residences. If you have not returned your survey yet, please drop it off at the Town Hall. We want to hear from you! The survey results will be presented at a Visioning Workshop on Wednesday, April 28th. At the Visioning Workshop you will have an opportunity to meet the people serving on the Smart Growth Planning Committee

by *Edmond P. Minihan, Dunn Town Chair*

The Sandhill Cranes are calling, announcing that it is Spring. Their calls and a whole host of other sounds, sights, and scents announced the renewal of the seasonal cycle. We have expended a great deal of effort to preserve a place for these natural events to occur. Most of the residents in our neighboring cities and villages share our appreciation of the natural world. There are some, however, who would destroy these places in the name of growth at any cost.

As of this writing, some officials in McFarland are revisiting crossing the Yahara and annexing land from the Town for the purpose of urban sprawl. In the Stoughton area, there are still plans to allow a Super WalMart near our border: again a sprawling of the city's border. Certainly our municipal neighbors can grow if they wish. It is a matter of growing responsibly and in a way that does not negatively affect the Town of Dunn. In the case of the Stoughton ( or Oregon ) WalMart, it is a matter of not destroying the character of the local community and the local businesses that are an extremely important part of the community. Stoughton has a vital downtown and it is unthinkable that city officials would endanger what the community has worked so hard to create. As citizens of this area, we have

*Help Shape Your Town's Future*  
**CITIZEN VISIONING WORKSHOP**  
**WEDNESDAY APRIL 28**  
**7:00 PM - 9:30 PM**  
**DOORS OPEN AT 6:30 PM**  
**DUNN TOWN HALL**

The meeting agenda includes:  
 A brief overview of the Town's Comprehensive Planning process, an analysis of the Town's survey results and small group discussions about YOUR vision for the Town's future.

and discuss some of the themes found in the survey.

This Visioning Workshop is a critical step in our process of updating the Town's Land Use Plan and shaping Dunn's future. Your participation is key to making this process work. Please plan to attend this important event.

a responsibility to support the local businesses in the neighboring communities and in our own town.

We need to think regionally-to consider what impact our governmental decisions have on our neighbors. We think regionally, but this is not always the case with our neighboring communities. It is unfortunate that we must sometimes defend our quality of life from the imposition of those who would injure it for the sake of misguided notions of growth at any cost or for personal gain. Bear in mind that much of the assault on our quality of life is directed by those who want to make a lot of money at our expense. We have exactly the same choice we had a quarter of a century ago: we can let events overtake us by not confronting the threat, or we can fight for what we have-what we as a community have preserved. It is extremely important that all of us connect with neighbors who share our love of stable and sustainable communities.

Remember that you deserve what you have worked to create; a stable, sustainable, beautiful place to live and raise future generations.

**TOWN OF DUNN**  
**ANNUAL MEETING**  
**TUESDAY APRIL 13, 2004 7:00 PM**

**A G E N D A**

- I. Minutes – Special Town Meeting of November 18, 2003
- II. Announcements and introductions by Chairman Minihan.
  - A. Comments by Chairman Minihan
  - B. Donations, if any.
- III. Reports
  - A. Building Inspector Report
  - C. Cemetery Report
  - D. Police Report
  - E. Parks Commission
  - F. Plan Commission
  - G. Land Trust Commission
- IV. Financial Report
  - A. Sanitary Districts - financial reports.
  - B. Treasurer's report - review 2003 audit.
- VI. New Business
  - A. Consider purchase of Conservation Easements on properties with pending applications in the Purchase of Development Rights Program.
  - B. Present the Noxious Weed Notice.
  - C. Any new business from the floor.

**Rosalind Gausman, Clerk Treasurer**

Every resident of legal voting age present can cast a vote at the Annual Town Meeting. This year, take an active role in your government and attend the Annual Meeting.

Agendas and announcements for all special meetings are posted at the following locations:

- 1) Bulletin board outside the Dunn Town Hall at 4156 County Road B.
- 2) Christy's Landing, 2952 Waubesa Ave.
- 3) Quick Stop, 1888 Barber Drive.

*Rosalind Gausman, Town Clerk Treasurer*

**Town of Dunn**  
**4156 County Road B**  
**McFarland, WI 53558**

PRSR STD  
 US Postage  
**PAID**  
 Madison, WI  
 Permit No. 1027

# ALL ABOUT DUNN

**Brief History** - Did you know that Dunn was originally part of Oregon and Fitchburg and was called Rome? When these three areas were divided into separate townships, Dover was the name chosen for the town. When the clerk of the State Assembly assigned the name, however, he misread the name and Dunn was entered. So it remained Dunn. This was in 1848, the same year Wisconsin became a state.

The first town meeting was held at the home of Alvah W. Wetherby on April 4, 1848. An election was held with 23 votes cast. The offices elected included a Chair, two Supervisors, Clerk, Treasurer, Justice of the

Peace, Assessor and School Commissioners. The government of the town was based on the New England form of government, and this form of political rule continues to this day.

For some time the area of McFarland was a part of the town of Dunn. It was the only village in the township. The village of McFarland was laid out on Section 3 of the town of Dunn. It wasn't until December 27, 1919 that a court order handed down by Judge E. Ray Stevens, incorporated the tiny village, thus removing it from the jurisdiction of Dunn's government.

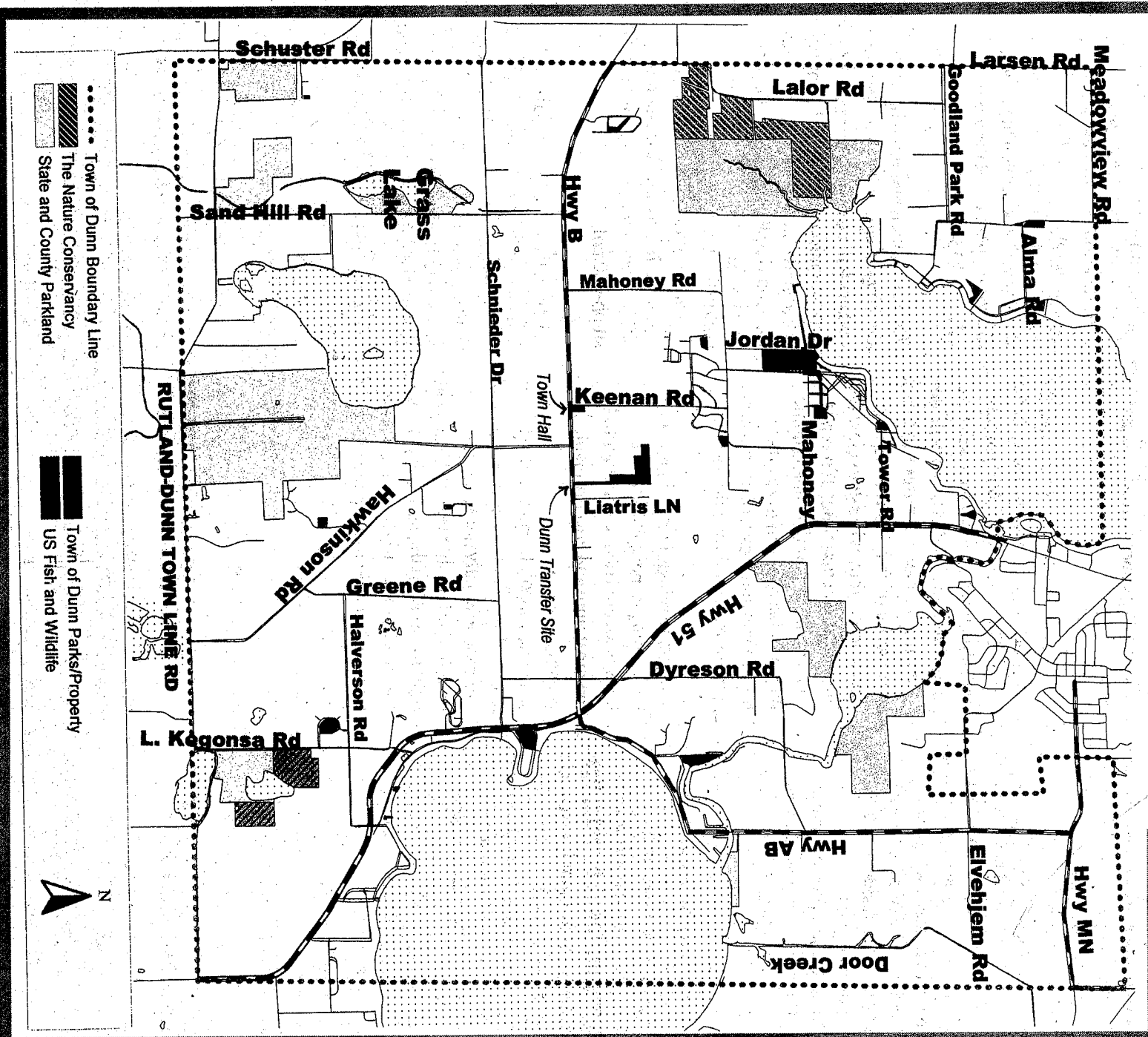

## MORE ABOUT DUNN

Wheat was the primary crop of the town's early settlers until about 1870, when the chinch bug reached the town on its devastating march northward. Farmers then changed to dairy, livestock, corn, and tobacco as their primary pursuits. This agricultural pattern remains today, although the number of dairy herds have declined significantly.

- In response to intense development pressures the Dunn Town Board created a Plan and directed it to prepare a land use plan consistent with the values of the people of the

- town of Dunn.
- Dunn's first Land Use Plan was adopted in June of 1979. This plan provided for the preservation of agricultural lands and open spaces while allowing limited residential development.
- Preserving agricultural lands, open spaces and viewsheds are still key components of Dunn's Land Use Plan.
- Dunn has 5 lakes: Lake Waubesa, Lake Kegonsa, Grass Lake, Hook Lake and Lower Mud Lake.

Number of Taxable Parcels		
Municipality	% of Parcels	Number of Parcels
T. Dunn	30.2	676
C. Monona	17.8	399
C. Madison	16.7	374
T. Pleasant Springs	11.6	259
V. McFarland	6.7	151
T. Westport	5.5	123
C. Middleton	4.8	108
V. Maple Bluff	4.6	104
V. Shorewood Hills	2.1	48

Note: Counts treat multi-residences/condos as one parcel

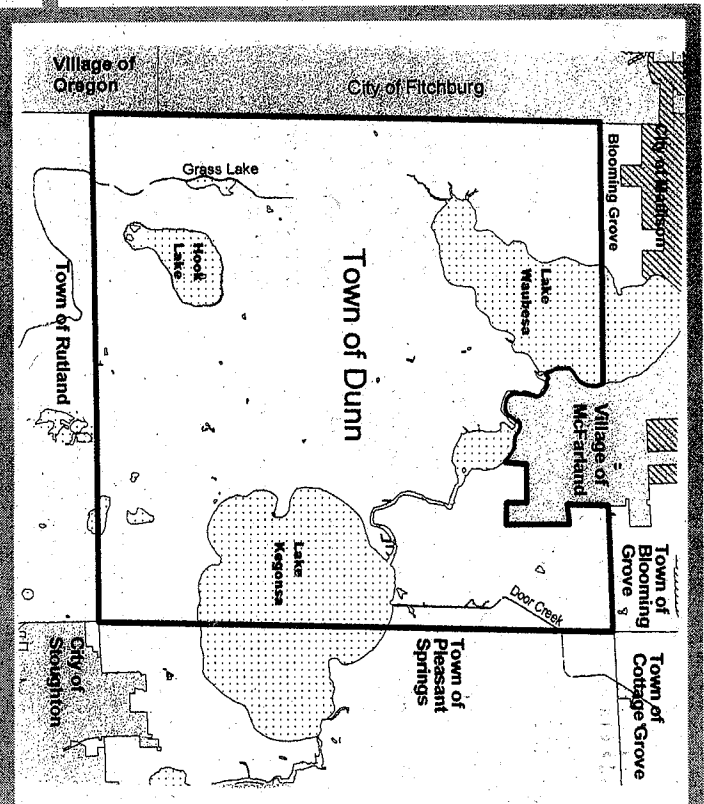

### Special Gifts



*There's no better way to honor friends or family members who love the Town of Dunn's farmland and natural beauty than by helping to protect it.*

*A donation to the Town's Rural Preservation Trust Fund can help preserve a woodlot, protect farmland or a prairie or special place. Consider a donation to commemorate a birthday, wedding or anniversary, or in memory of a loved one.*



- Dunn has a greater concentration of high-quality wetland areas than any other township in Dane County.

- Dunn has more taxable waterfront parcels than any other municipality on the Yahara Chain of Lakes.
- In 2000 the median age in the town of Dunn was 40.4 years. This is older than Dane County's median age of 33.2 years.
- 91.9% of the town's population that is age 25 or older hold high school diplomas and 30.9% of town residents hold a bachelor's degree or higher.
- In 2000 there were 2,029 households in Dunn.

The population of Dunn in 5,300 with 51.3% male and 48.7% female

## Are you concerned about the impacts of natural disasters on your home or livelihood?

If so, then this is an opportunity for you to express your ideas and concerns. The Town of Dunn is holding a public meeting to discuss strategies for reducing losses caused by natural hazards. The meeting will be held on April 20 at 7:00 PM at the Town Hall.

The Town is working with Dane County Emergency Management on a cooperative effort to produce a natural hazard mitigation plan. The purpose of this plan is to assess the impact of natural hazards and then to develop a strategy with long-term solutions and alternatives for addressing the problems.

While we can't prevent natural events such as tornadoes or flooding from occurring, we may be able to reduce the impact of these events when they do occur. Monetary losses can be reduced. Damages to homes and other buildings can be reduced. Personal injury and loss of life can be reduced.

But, we need your input. By attending this meeting, you will have the chance to talk directly with County and Town officials who have been working on this planning project. You will also have the chance to review and comment on the initial findings. Some examples of these include:

- Vulnerability to fire taking entire neighborhoods in severe storm

## PLAN COMMISSION UPDATE

by *Jim Molloy,*  
*Plan Commission Chair*

The Plan Commission continues to process land divisions, re-zonings, driveway permits and other land use requests. We meet at 7:00 PM the second Monday of each month and welcome the public to our open meetings. We always post our agenda outside the Town Hall and on our web page. To be placed on our agenda, please contact Renee Lauber at the Town Hall at 608-255-4219, extension 4.

Also, as part of our continuing desire to update our Land Use Plan, we notified the public on January 12, 2004 about the Land Use Plan Review Period and posted this information on our web page. We received no public comments.

The Plan Commission consists of the following seven individuals: Tim Andrews, Loraine Gardner, Steve Greb, Dean Hein, Jim Molloy, Bob Uphoff, and Vicki Wangerin. Occasionally a vacancy occurs on the Commission. If you are interested in serving your Town as an uncompensated member of this Commission, please indicate your interest to Roz Gausman, Town Clerk.

## Property Revaluation Underway

By *Rosalind Gausman, Clerk/Treasurer*

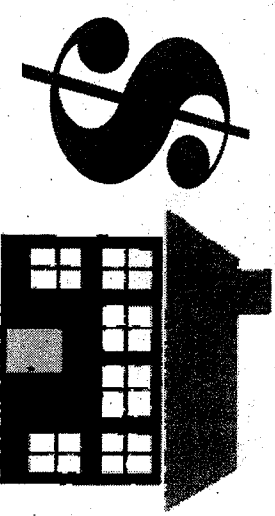

The town signed a contract with our assessor at Gardiner Appraisal Services, Inc. to do a revaluation of all real estate and personal property. The town's assessment valuation is at 70% and needs to be raised to 100%. The town-wide revaluation will not affect the 2004 assessments. Any changes in assessment in 2004 will only reflect changes made to the property since January 2, 2003 through January 1, 2004. The revaluation will reflect the value of the property as of January 1, 2005.

The process begins this year when the assessor will visit each property in the town. There are over 2,000 parcels with structures on them so it will take several months. The assessor will stop by during the day to measure and view the exterior of all buildings. If someone is home, they will ask to view the interior also at that time. If it is not a convenient time or if no one is home, they will leave a card to say they missed you and they will send you an appointment card for a future date.

They try to schedule appointments in the evening by neighborhoods or houses located near each other to be the most time and cost efficient. If you miss your scheduled appointment you will be sent a second appointment by certified mail. This is to officially notify you, as required by law, that you will lose your right to appeal if the assessors are not able to view the interior of the house. If you are unable to keep the any

The assessor will have a picture identification card that identifies them as an employee of Gardiner Appraisal Service and an introduction letter from the Town Clerk. If you have any questions, please call the town hall office at 255-4219.

The revaluation will be completed for the 2005 Board of Review. Property owners will be mailed a notice of their new valuation along with the date of scheduled Open Book Sessions and the Board of Review date. Department of Revenue has prepared a Guide For Property Owners that explains property assessment and taxation. It is available at their web site at <http://www.dor.state.wi.us/pubs/sif/pb-060.pdf>

A new software program will be used that makes the assessment information accessible on computer rather than on field cards as in the past. New digital pictures will be taken of all properties. The cost of the revaluation is \$70,400, plus postage and maps.

## Frequently Asked Questions and Answers About Assessments:

### Q - Why is the revaluation necessary?

Wisconsin law requires municipalities to assess property within 10% of market value within each four-year period. In 2005 our assessment will be below 90% for the fourth year.

### Q - How does the assessor go about placing a "fair market value" on my property?

Finding the market value of property involves reviewing what similar properties are selling for, what the property would cost today to replace and what financial factors, such as interest rates, may be affecting the real estate market. Valuation techniques for commercial properties also include analysis from an investment point of view. The assessors do not create value. Rather, they have the legal responsibility to discover and report the changes that are occurring in the market place.

**Q - How can my assessment go up when my property hasn't changed?**  
Since the new assessments will be set at market value, rising real estate

values in the town will be reflected in generally higher assessments. All properties, however, do not change in value to exactly the same degree. Many factors influence the value of property, including location, age, size and style.

### Q - Will my home be inspected?

An experienced appraiser hired by the town will make a personal visit to your property. The appraiser will need to walk through the interior of your home and also walk around the exterior. The appraiser will be carrying identification and a letter of introduction from the Town of Dunn. If you refuse to let the assessor view your property you lose the right to appeal the value placed on the property by the assessor.

### Q - Will the assessors make an appointment to view my property?

The assessors start by visiting a neighborhood and viewing as many properties as they can without making appointments. The properties not viewed on their initial visit will be sent cards notifying the property owner of a scheduled appointment in the future.

Failure to let the assessor view the property at that time will result in a certified letter to the property owner with the final appointment time.

### Q - What if my house is a mess and I don't want the assessor to view it when he stops by?

The assessors don't mind if your house is not tidy. They are only viewing the interior to determine the general condition of the home, note the features, and count the number of rooms and fixtures in the home.

### Q - How will I know what my new assessment is?

All property owners will receive a notice of assessment change by mail in 2005 when the revaluation of the whole town is finished.

Watch for articles in future newsletters about the dates and procedures for viewing the assessment records and appealing assessment values. If you have questions you may contact the Town Clerk, Rosalind Gausman at 255-4219 Ext. 6.

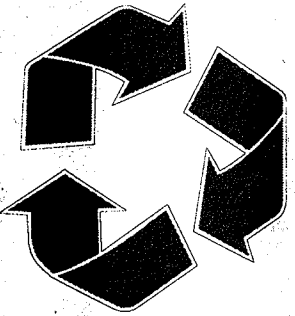

## TOWN OF DUNN'S

### Do your Part to reduce, reuse and recycle

## Curbside Recycling

Dunn residents have several ways to recycle material. Common recyclables such as household plastics, glass, aluminum, aerosol and tin cans, cardboard and newspaper are picked up by Waste Management in the weekly trash and recycling pickups each Wednesday.

Because wet paper products may not be recycled, withhold cardboard, newspaper and other paper recyclables for later pick-up if it is raining on Wednesday morning, or if the forecast indicates rain is likely.

**Plastics** - *Numbers 1, 2, 3, 4, 5, 6, and 7 plastics are now recyclable!* Rinse and remove caps and rings; labels can remain. Flatten as much as possible. Bottles that have contained motor oil, medicine or chemicals cannot be accepted for recycling. All #2 plastic one and five gallon buckets can not be recycled.

**Aluminum** - only aluminum cans are accepted for recycling. Rinsing is encouraged. Don't include any other kinds of aluminum such as foil or aluminum pie plates in the recycling bin.

**Tin Cans** - Food cans only - no paint or chemical cans. Rinse, remove labels, and flatten. Please put sharp lids in the trash.

**Aerosol Cans** - can be recycled! Make sure they are empty and remove plastic nozzles.

**Glass** - Jars and bottles are accepted for recycling. Always rinse and remove the lid. Labels can remain on the container. Light bulbs, dishes, drinking glasses, mirrors and window glass can be recycled elsewhere or disposed of as trash.

**Newspaper** - Newsprint must be dry and bundled. Shiny inserts are acceptable. Place in brown paper bags. Do not mix with other types of paper!

**Magazines** - Magazines and catalogs must be in bundles and tied with string in 6 inch stacks. Do not mix with other types of paper!

**Mixed Paper** - Junk-Mail, Office Paper, Soft drink/Beer cartons can be recycled. Place in brown paper bag. Do not mix with newspapers or magazines!

**Cardboard** - Corrugated cardboard can be recycled. Flatten boxes and keep dry. Cut pieces into less than 3 foot squares and bundle with string or place in a grocery bag. Pizza boxes, egg containers and wax-coated boxes can not be recycled.

## Waste Management Curbside Pick-up

Each household is allowed one thirty four-gallon container for solid waste and an unlimited volume of recyclables. The charge is included on your tax bill each year.

For additional volume pick up contact Waste Management. For a fee they will provide an extra 64-gallon toter or an extra 96-gallon toter. These toters may be filled in addition to the usual 34 gallon container allowed. Cost is billed directly to the homeowner. At the time of this publication the cost of the 64 gallon toter was \$3.75 per month and the cost of the 96 gallon toter was \$5.20 per month.

Items that are too big to fit into a 32 gallon receptacle such as mattresses, chairs, couches, etc. can be arranged to be picked up by calling (608) 273-2500 at a cost of \$25.00 per item. These items are not picked up the same day as your normal service. Your service customer representative will determine this at the time of your order. Appliances such as washers, dryers, refrigerators, etc. can also be scheduled for pickup at the cost of \$25.00 per item by calling (608) 273-2500.

Waste Management can also help you with your remodeling needs or cleanup. Please call (608) 273-2500 on the cost of renting a dumpster.

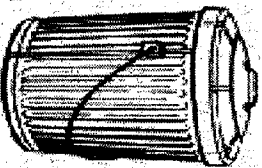

## Town of Dunn Transfer Site

*4030 County Road B 1/4 mile east of the Dunn Town Hall*

Open the 1<sup>st</sup> and 3<sup>rd</sup> Saturdays of every month from 8 AM to 4 PM. During daylight savings from April 7 - October 29 the transfer site will be open additional hours on Wednesday from 3 PM - 4:45 PM.

The Transfer Site accepts:

- Scrap Metal
- Motor Oil
- Yard Waste
- Brush and Wood
- Batteries
- Tires

**Transfer Site Recycling Scrap metal** - Scrap iron, steel, copper, and other metals are accepted. We don't accept compressors or motors.

**Motor oil** - Used motor oil that is free of other liquids such as antifreeze is accepted. Either reuse your used motor oil container or dispose of it in the trash. Don't leave oil containers near the used oil tank.

**Leaves and grass clippings** - Put any compostable material in the compost pile at the Transfer Site, or compost them yourself at home.

**Brush and Wood** - We take brush and limbs that are free of soil. We cannot take stumps or painted lumber. Dane County's landfill will take tree stumps.

**Tires** - We charge \$3 for auto tires \$4 for tires with rims. Tires (rims removed) can be taken to the Dane County Landfill for about 85 cents each.

Questions? Call the Town Hall at 255-4219

### DANE COUNTY COMPOST SITES OPEN EARLY APRIL

Yard wastes are banned from disposal at all landfills in the State of Wisconsin. Dane County will open its three yard waste compost sites in early April. All sites are available for people to bring non-woody yard waste to be composted. Verona site will have finished compost available for pick up. Unscreened compost is free for the general public. There is a fee for screened compost.

**VERONA SITE HOURS:** Tuesday - Saturday 8:00 a.m. - 3:30 p.m.

Located adjacent to old landfill at Badger Prairie Park (Take USH 18-151 one toward Verona. Exit Business District and turn right to Badger Prairie Health Care Center/Badger Prairie Park parking lot. Turn right at compost site and follow gravel road to site). An end loader is available on site. The compost sites accept only non-woody plant material. They do not accept brush, Christmas wreaths or garlands (because of the metal wire), or trash of any sort, such as pieces of fences, plastic bags or Styrofoam, plastic lawn edging similar material.

For more information on the Dane County compost sites, Call Al Czecholinski at 266-4139

## Goodwill Industries Pick up

The next Goodwill Industries pick up is scheduled for **Saturday, April 17<sup>th</sup> from 9 AM to 12 PM** in the Town Hall parking lot.

Goodwill will provide the staff to help unload, give receipts and provide tax information.

*The town will only accept donations during the scheduled drop-off dates/times.*

# 2004 RECYCLING GUIDE

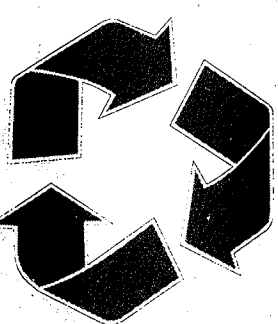

## Home Composting

Composting is a great way to keep organic material out of the waste stream. It saves tax dollars and provides you with a valuable soil additive. Composting is easy to do if you follow a few simple guidelines.

1. Use a bin. A simple wire enclosure will do. A bin keeps your pile neat and helps retain heat and moisture, two key elements of the compost process.
2. The key to a good working compost pile is a balance of green materials, such as grass clippings or food waste that is high in nitrogen and brown material, such as leaves, that are high in carbon. A good rule of thumb is to maintain a 50-50 ratio by weight of green and brown material.

3. If you are going to compost kitchen waste, bury the material 6-12 below the surface. This keeps flies away from your pile. Compost only vegetable and fruit waste. Do not compost meat, fats, gravy or pet waste.

4. Don't forget moisture. A compost pile should be damp so be sure to add water to dry material as you build your pile. Don't over water. Materials should be as damp as a wrung out sponge.

### Building a Compost Pile

**First layer:** 3"-4" of chopped brush or other coarse material on top of the soil surface allows air circulation around the base of the heap.

**Second layer:** 3"-6" of green material, grass clippings, or food waste.

**Third layer:** 4"-8" of "brown" material, such as leaves. Add water as needed.

**Fourth layer:** 1" of soil serves as an inoculate by adding microorganisms to the pile.

**Fifth layer:** Repeat steps 2-4 until the bin is almost full. Top off the heap with a layer of leaves or straw and scoop out a "basin" at the top to catch rainwater.

### Maintaining Your Compost Pile

A properly made compost pile will reach temperatures of 140-160 degrees F in four or five days. At this time you'll notice the pile "settling," a good sign that your pile is composting properly. After 4 or 5 weeks, turn the pile, putting material from the outside of the pile into the center of the new pile. Add water if necessary. You shouldn't need to turn your heap a second time. Your compost should be ready in 3 to 4 months.

Information provided by *Dane County* at [www.co.dane.wi.us](http://www.co.dane.wi.us)

## Recycle old computers on Saturday April 17

### Protect our waters from heavy metal contamination

Any non-business computer equipment or television may be dropped off for reuse or recycling. There is a cost to recycle some products. Items with reuse potential will be tested and cleaned (data erased from hard drives) before being donated to local charities. Damaged and obsolete equipment will be recycled.

Anyone can drop off equipment, as long as the equipment is personally owned and not from a business or institution. There is a limit of 2 computer systems and 2 televisions per vehicle.

**DATE:** Saturday, April 17, 2004 from 9:00 a.m. -2:00 p.m.  
**LOCATION:** Cascade Asset Management, 2601 Seiferth Road, Madison. It is on the east side near the intersection of Stoughton Road (Hwy 51) and Pflaum Road, about 1 mile north of the Belline (Hwy 12/18).  
**COST:** \$5.00 per monitor, terminal or laptop computer.  
 \$25.00 per TV\*  
 Other computer equipment - no charge

\* No cost to participants to drop-off Sharp and Panasonic (includes Quasar) brand TVs. Sharp and Panasonic have graciously offered to cover the cost of recycling their televisions.

**QUESTIONS:** Call the City of Madison at 608-267-2626 or Cascade at 608-222-4800.  
**SPONSORS:** Cascade Asset Management, City of Madison, Dane County, Madison PC Users Group, Sharp Consumer Electronics, and Panasonic.

## MEDICAL WASTE

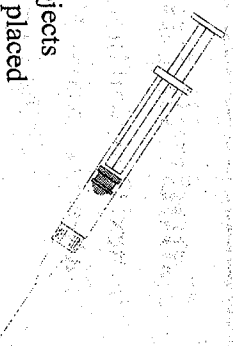

Waste Management, the town's trash hauler will pick up medical waste and sharps that are properly labeled and sealed. Sharps - Sharp objects such as needles, syringes, or lancets should be placed in a hard plastic or metal container that is puncture resistant and labeled "SHARPS". An empty laundry detergent jug or a red medical sharps container work well. Never use recyclable aluminum cans, glass or clear plastic jugs to dispose of sharps. Containers may then be placed next to your trash for pick up by Waste Management on regular trash pick up days.

## Protect Our

**Groundwater - Dispose of paints, pesticides, fuel & more at Dane County's Clean Sweep Site**

Located at 2302 Fish Hatchery Road

Visit [www.danecountycleansweep.com](http://www.danecountycleansweep.com)

or call the new *Information Hotline* at 294-5366

There are plenty of household hazardous materials like paints, pesticides, and solvents that can't be disposed of in the trash, or could harm groundwater or the environment if not disposed of properly. The proper place to take these substances is Dane County Clean Sweep located behind the Dane County Highway Garage, north of the Beltline on Fish Hatchery Rd. This service is free of charge to all county residents, but is limited to households only. For disposal of hazardous waste generated in small business, please call cleansweep for instructions.

**Paints & Paint-Related Products** Latex paints if container is greater than 1/3 full, oil or solvent-based paints including automotive paints, solvents such as finish removers, stain, varnish, thinner, turpentine, and furniture strippers.

**Pesticides & Poisons** Mercury, cyanide, stump remover, pool chemicals, herbicides, insecticides, pesticides including: *Aldrin, Chlordane, DBCP, DDT, Dieldrin, Endrin, Heptachlor, Kepone, Lindane, Mirex, Silver, Tosaphene, 2,4,5-T.*

**Household Products Containing Organic Solvents**

Photographic Fixer, pastes, polishes, caulks that are combustible or flammable. Check the label for *Mineral Spirits, Petroleum Distillates, Phenol, Carbon Tetrachloride, Benzene, Diethyl or Dimethyl Phthalate, Methylene Chloride, Toluene, Xylene, Chlorinated Solvents.*

**Ignitables & Aerosols.** Aerosol cans, propane cylinders, gasoline, kerosene, fuel oil, driveway sealant (if not hard).

**Product Exchange** Need a pint of stain or gallon of basement paint?

Does your roof need patching or are you stripping a piece of furniture? Have the insects gotten to your roses? Let the Clean Sweep & Product Exchange be your source. Products brought in by you and your neighbors that are perfectly good and usable are made available, free of charge, for you to use up around your home, yard, farm, or on your vehicle. Special requests taken. Products and materials should be packaged to keep them from spilling or breaking on the way to Clean Sweep. Leave materials in their original containers. Do not mix like or unlike materials together. Leaking containers may be placed, as is, in another container. Label that container.

**Clean Sweep Hours:** May 1 through October 30 on Tuesday, Wednesday, Friday, Saturday from 7:30 AM to 2:00PM

For more information call the information hotline at 294-5366 or visit the website at [www.danecountycleansweep.com](http://www.danecountycleansweep.com)

## Compost Bin Sale - One Day Only! Saturday May 1, 2004

Dane County is once again offering the popular "Earth Machine" home composting system to homeowners at a one-day special sale, Saturday, May 1, 2004. The regular "Earth Machine" composting unit costs only \$33. Compost bins are 36" X 36", will fit into any car and will be on sale at the following locations:

Site	Address
Madison	Alliant Energy Center, no charge for parking.
Fitchburg	City Hall, 5520 Lacy Road.
Stoughton	Street Dept Garage, 515 S. Fourth Street.
Sun Prairie	City Service Center, 901 S. Bristol Street; and,

Times have not yet been determined. Call 261-9111 for times and further information. Or visit website [www.cityofmadison.com/streets](http://www.cityofmadison.com/streets)  
 Be prepared to have cash or a check since credit cards will not be accepted.



## On the Road Again...

By Todd Klahn, Highway Foreman

Bids have already been received for roadwork this year. Roads planned to be repaved include all the roads in Waubesa Heights and Vic Anderson Road. Sealcoat projects include the town owned roads in Bayview Heights, a portion of Tower Road, High Street, Morris Park Road, Willow Court, and Crescent Drive.

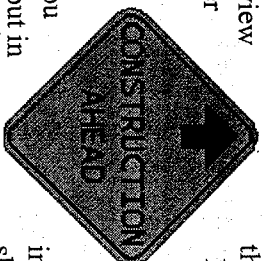

You may ask, "Why are you sealcoating the roads you put in new last year?" The reason is to prolong the life of the oil in the black top. A road that has not been sealed lasts about fifteen years and a sealed road last about thirty years.

We have several culverts that need to be replaced this year. Four culverts in the Waubesa Heights subdivision, four on Mahoney Road west of Tower Road, and two on Stace Road.

Just a reminder to residents - road right of way is generally 33 feet from the center of the road. In addition to the paved surface, this area is used by the town for road maintenance

like snow removal and surface water drainage. Maintenance also includes tree and brush control. It is important to prevent densely shaded areas on the pavement the blackout. Therefore, it is sometimes necessary to remove whole trees instead of just trimming.

Due to budget cuts we reduced new road construction by \$25,000 and eliminated any new equipment except the annual upgrade of the Skid Steer.

## Late Lottery Credit Applications

The current Lottery and Ganning Credit law provides authorization to grant the credit to a person who owns and uses a home as their primary residence as of the January 1 certification date. Additionally, the 2003 credit may be granted to a person who purchased a home during the 2003 calendar year if the person purchased the home from someone who used it as a primary residence on January 1, 2003. The municipal clerk is able to make corrections for claims made up until January 31, 2004.

If you are eligible for a lottery credit and missed the deadline to make a claim at the local level, you can file a late claim with the Department of Revenue. Forms for a Late Lottery Credit Claim are available on-line at <http://www.dor.state.wi.us/html/lottery.html> or from the Town of Dunn. The deadline for filing a Late Lottery Credit Claim with the State Department of Revenue is October 1, 2004.

## Take a Stake in the Lakes

Dane County's  
Cleanup Event 2004

The Take a Stake in the Lakes volunteer cleanup of the Yahara Lakes will be held on June 12 and June 19, 2003. Lake Kegonsa will be cleaned on Saturday, June 12 from 9:00-1:00, with the information center at Wingra Park in Madison. Lake Waubesa will be cleaned on Saturday, June 19 from 9:00-1:00, with the information center at Law Park in Madison. Garbage bags and stencil kits will be available at the information centers.

During Take a Stake in the Lakes groups, individuals and families adopt a beach or shoreline, collect litter and rake aquatic debris from the shoreline and shallow waters. Some adopt boat launches, and some clean rivers while padding their canoes or kayaks. Many groups then have a picnic in the park they've just cleaned up. Garbage bags, T-shirts and door prizes are provided.

Call now to find out how you can help protect our beautiful lakes. For more information call 608-224-3601

## TOWN OF DUNN PHOTO CONTEST

The town is looking for a few good photos. Can you capture Dunn's unique charm with your digital camera? Landscapes, waterways, agriculture, community events, recreation, business, wildlife and other subjects are needed for possible use in the town's website, future newsletters or other purposes. All contributors will receive a certificate of recognition from the town. Photos become property of the town and may be featured on the town website or other publications.

### Rules for the Town of Dunn Photo Contest

1. Photos must be digital format or scanned to digital.
2. Photos must be taken in the town of Dunn.
3. Entries must be submitted by email to [townhall@town.dunn.wi.us](mailto:townhall@town.dunn.wi.us).
4. Email should include: name, address, and contact information for the entrant, location and identifying information about the photo. Every effort will be made to credit the contributor when the photo is used, but the town assumes no liability for errors or omissions. Entrants who wish to remain anonymous should indicate that in their emailed submission and their photo will not include a credit.
5. Entries are due by May 31, 2004.
6. Late entries are welcome and will automatically be entered in the Fall Photo Contest.
7. Signed release must be provided for any people featured in photos.

Please contact Cathy at 255-4219 ext. 3 to obtain a release form or for more information about the photo contest.

## YAHARA LAKES WATER TRAIL GUIDE BEING DEVELOPED

By Mindy Habecker, Dane County  
UW-Extension



The Dane County Environmental Council has put together a steering committee for the development of an educational water trail guide for the Yahara Lake system. The guide will include points of historical, archeological, natural resource features and landmarks that can be viewed from the water. The area of water to be covered in the guide includes Cherokee Marsh, the entire chain of Yahara Lakes (Mendota, Monona, Wingra, Waubesa, Upper and Lower Mud Lakes and Kegonsa) and the Yahara River from Cherokee Marsh south to the Rock County boundary.

It is the intent of the steering committee for this project that the guide will have both a printed and a more detailed electronic format. It will be developed over the next year with the hope that it will be both educational and a pleasure to use. The Dane County Environmental Council is a county committee designed to assist public and private groups in recognizing and protecting the natural areas in Dane County and to assume an educational role in the environment's protection. For more information on this project, contact Mindy Habecker, Dane County Environmental Council staff at 224-3718.

## Area Senior Centers Welcome Town Residents

Seniors who have not been in touch with their Senior Center are encouraged to call or visit. A surprising variety of low cost or free services and events are provided. While exact services vary from one Center to another, you can expect to find meals, social activities, transportation to medical appointments and shopping, crafts and hobbies, peer support, and outreach.

assistance, Community Options Programs, Social Security and S.S.I.), housing, medical equipment on loan, meal programs, transportation, and adult day care programs.

**McFarland Senior Center**  
5915 Milwaukee Street, McFarland,  
WI 53558  
608-838-7117

**Stoughton Senior Center**  
248 W Main St, Stoughton, WI 53585  
608-873-8585

Outreach Workers are available to assist senior citizens and disabled adults to secure resources which allow them to remain in their own homes. Outreach Workers can assist with finances (Medical Assistance, homestead credit/deferred loan, fuel

**Oregon Senior Center**  
219 Park Street, Oregon, WI 53575  
608-835-5801

## AREA YOUTH CENTERS SERVING TOWN RESIDENTS

### Looking for something to do after school?

Youths are encouraged to call or visit our local youth centers. Adult supervision and activities are typically available for middle school students during the after school hours from 3pm to 6 pm. Some programs may be available for non-school days. Contact the youth centers directly for more information:

**McFarland Youth Center**  
5120 Fairwell St., McFarland  
608-838-4508

**Stoughton Youth Center**  
518 S Fourth St., Stoughton  
608-873-3880

**Oregon Youth Center**  
110 N. Oak St., Oregon  
608-835-0822

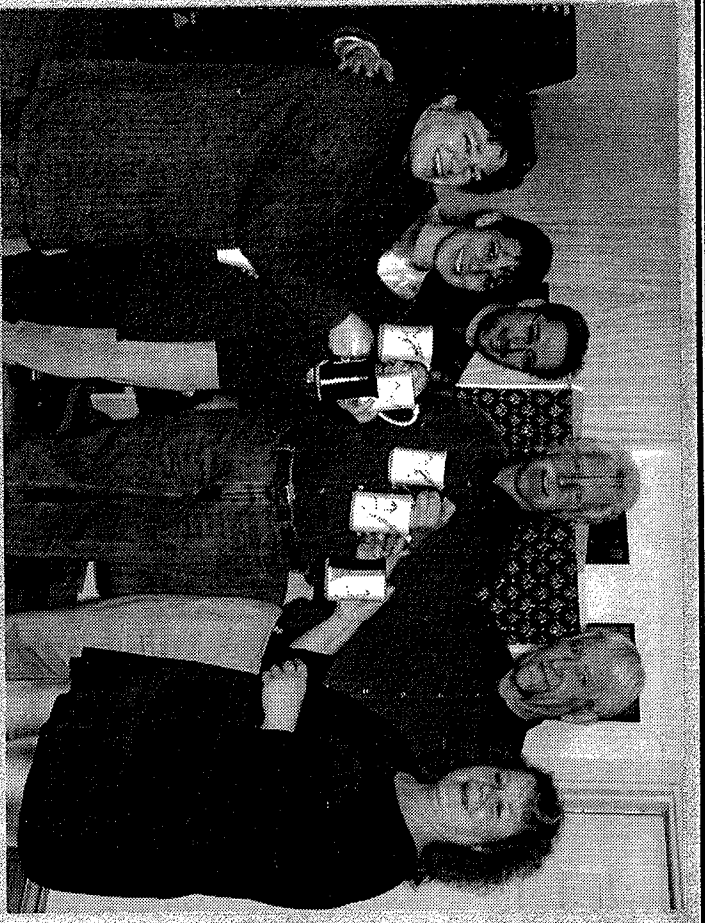

Parks Commissioners show off their 2003 appreciation mugs presented to them at the Annual Joint Commissions meeting. The mugs are created by local potter, Meredith Greene and feature an image of a Sandhill Crane, the town's wildlife symbol. The mugs are inscribed with the commission served and the year. The keepsake mugs are presented to volunteer commissioners on the Plan, Parks, and Land Trust Commissions. Parks Commissioners clockwise from left: Nancy Hagen, Sue Richards, Tom Sheperd, Don Schmidt, Dave Schmitt, Susan Priebe, Chair. Not pictured: Kurt Krumholz

## Park Commission Update

*By Susan Priebe, Parks Commission Chair*

The Parks Commission welcomes new commissioner Kurt Krumholz. Kurt has a special interest in bike trails and we look forward to working with him in 2004 and continuing our efforts to improve Dunn's parks.

Spring will officially be upon us when you receive your newsletter and a time to renew outdoor activities with your family and friends. Take time with the longer days, lack of snow cover to find some of the unique places (parks) in our wonderful community.

We have planned the following events for you to enjoy:

- The Arbor Day celebration, May 1, 2004 at the town hall, which is complete with potluck, interesting talk (great for families) and presentation of the Stewardship Award. This has always been much fun for people of all ages...

- Parade of Prairies scheduled for Saturday, August 7, 2004 (Raindate August 8th). This is a self-guided event, which gives you an opportunity to see what your neighbors have done with prairie restoration on their property.

If you have a prairie or rain garden that you would like to have in this tour, or if you would like to nominate someone for the town's Stewardship Award, please contact Mary at 255-4219 ext. 1.

We are always looking for ways to help the community come together for fun and food. So, if you have any ideas for other events (maybe this fall), please contact Mary at 255-4219 with your suggestions.



## At the Town Parks...

*By Jay Hoel, Public Works Superintendent*

Spring is a wonderful time to visit the town parks. Dunn Heritage, Colladay Point, Simkao, and Orvold Park Nature Conservancy each offer a unique variety of plant and wildlife species. All have beautiful trails or mowed open areas for residents to enjoy. Dogs are welcome, but must be on leashes at ALL TIMES. Also remember to be a responsible pet owner and clean up your dog's waste.

Some town residents have expressed interest in upgrading playground equipment in their neighborhoods. Matching funds are available of up to \$1500 per year for any park projects a neighborhood organizes and gets approved by the Town Parks Commission. This is on a first-come, first-serve basis.

### Don't Miss

#### Parade Of Prairies!

Saturday

August 7th, 2004

Raindate: August 8th

#### Arbor Day Potluck Celebration!

Saturday May 1, 2004

Starting at 4:00 p.m.

At the Town Hall  
4156 County Road B

### FREE SANDBOX SAND

We will have clean sand available for Dunn residents. Bring your own shovel, the sand is available on a serve yourself basis. Call or stop by the Town Hall.  
255-4219 ext 1

Everyone is welcome to attend. Participants are asked to bring a dish to pass. The Town will provide beverages and eating utensils. The stewardship award will be presented. Guest speaker to be announced.

#### Estimated Ending Fund Balances for 2003

Parkland Dedication Ending Fund Balance	17,496
Waubesa Heights Ending Fund Balance	1,424
Dunn Heritage Park Ending Fund Balance	22,825
Bike Path Ending Fund Balance	8,216
Orvold Park Ending Fund Balance	4,767
Rock Elm Park	3,439

## TAKE PRIDE IN OUR PARKS

Town Parks are for the enjoyment of all town residents, young and old. Please respect the parks and follow these simple rules:

Dog waste is an ongoing and serious problem that makes our parks unavailable and unsanitary for residents to enjoy. Dog walkers must clean up dog waste. Residents must not allow dogs to run at large or allow their dogs to leave waste on public or private property. This is a violation of town ordinance and a citation may be issued.

When you visit a town park, leave behind nothing but your footprints. Carry out any cans, litter, paper, food, or dog waste that came in with you.

Absolutely no motorized vehicles. Our Parks have suffered some damage this year due to off road activity which is prohibited on town property.

## Statewide Tornado Warning Drill

The National Weather Service will be conducting a statewide tornado drill on the afternoon of Thursday, April 10, 2004. The drill will include a test WATCH at 1:15 p.m. and a test WARNING at 1:45 p.m. The Dane County outdoor warning sirens will be activated for both drills.

In the event of severe weather anywhere in the state on the day of the drill, the test WATCH and test WARNING will be postponed until Friday, April 11. If severe weather is forecast on Friday the drill will be cancelled.

Tornado and Severe Weather Awareness Week in Wisconsin is scheduled for April 7-11, 2004. This awareness week is conducted in an effort to ensure that citizens are prepared to protect themselves and their property in the event of severe weather.



#### Wind Protection

If the area immediately surrounding your house contains trees, outbuildings, trash cans, yard debris, or other materials that can be moved by the wind, your house will be more likely to be damaged during a tornado. All storage sheds and other outbuildings should be securely anchored, either to a permanent foundation or with straps and ground anchors. Smaller objects, such as trash cans, barbecue grills, and outdoor furniture should be anchored or, if you have adequate warning moved indoors.

**HOW TO CONTACT YOUR  
ELECTED OFFICIALS****TOWN OF DUNN****TOWN CHAIR**

Edmond P. Minihan  
2379 Keenan Road  
McFarland, WI 53558  
838-6432 (home)

**TOWN BOARD SUPERVISOR I**

Stanley Solheim  
2380 Lattis Lane  
McFarland, WI 53558  
835-5818 (home)

**TOWN BOARD SUPERVISOR II**

Steve Greb  
1714 Ldbrodder Road  
Oregon, WI 53575  
835-5266 (home)

**CLERK/TREASURER**

Rosclind Gausman  
2314 Keenan Road  
McFarland, WI 53558  
255-4219 ext. 6 (office)

**MUNICIPAL JUDGE**

Robert H. Schneider  
255-4219 ext. 1 (office)

**DANE COUNTY****COUNTY EXECUTIVE**

Kathleen Folk  
210 MLK Jr. Blvd  
Madison WI 53709  
266-4114 (office)

**COUNTY SUPERVISOR (DIST 34)**

Kevin Kesterson  
6115 South Court  
McFarland, WI 53558  
266-5758 (office)

**STATE OF WISCONSIN****GOVERNOR**

James Doyle  
115 East, State Capitol  
Madison, WI 53702  
266-1212 (office)

**STATE SENATOR (DISTRICT 16)**

Chuck Chvala  
Room 130 South, State Capitol  
Madison, WI 53708  
266-9170 (office)

**ASSEMBLY (DISTRICT 48)**

Mark Miller  
112 North, State Capitol  
Madison WI 53708  
266-5342 (office)  
<http://www.legis.state.wi.us/assembly/asm48/asm48.html>

**ASSEMBLY (DISTRICT 46)**

Tom Hebl  
304 West, State Capitol  
Madison WI 53708  
266-7678 (office)  
<http://www.legis.state.wi.us/assembly/asm46/asm46.html>

**US SENATE**

Russell Feingold  
1600 Aspen Commons, Room 100  
Middleton, WI 53562  
828-1200 (office)  
[www.feingold.senate.gov](http://www.feingold.senate.gov)

**US SENATE**

Herbert Kohl  
14 West Mifflin St., Suite 207  
Madison, WI 53703  
264-5338 (office)  
[www.kohl.senate.gov](http://www.kohl.senate.gov)

## Sharing our Roadways

Spring is upon us and soon our roads and roadsides will be populated with pedestrians, bicyclists, horseback riders of all ages, and increased traffic of farm tractors and equipment. Motor vehicles should slow down when rounding corners and cresting hills until they can see what is beyond. Use caution when approaching or passing pedestrians and others. Special consideration should be exercised when passing horses on the road.

-Please do not honk or make sudden noises - it may startle the horse.

-Allow extra room and slow down.

For safety, motor vehicles must yield to pedestrians and equestrians!

## One Day Only Extra Curbside Garbage Pick up April 14th

Planning on cleaning out the garage or basement this spring? Wondering how to get rid of items too large to fit in your garbage can? Waste Management is offering extra curbside garbage collection on Wednesday, April 14th. On regular garbage pick up days, each residence can put out 32 gallons of trash plus unlimited recyclables for curbside pick up. On April 14th, residents can put out extra garbage at no additional charge. There are some restrictions. Appliances, tires, liquids, computers and construction materials may not be left at the curbside. Call Waste Management at 273-2500 for details.

## THANK YOU TO ROADSIDE PICKUP VOLUNTEERS

A big thank you to the volunteers involved with the adopt-a-highway program. 2003 participants included Shed Shed II, Covenant Lutheran Youth, the University Physical Science Laboratory and Christ the King Church in McFarland.

Call the Town Hall at  
255-4219 if you'd like to adopt-a-highway in the Town of Dunn.

## Yards, Roadsides, and Outdoor Areas Ready for Spring Clean-up

As the snow melts and spring winds blow, the litter that accumulated over the winter becomes more visible. This is a great time to tidy up the yard. We encourage everyone to participate in picking up a section of road before April 14th. The trash picked up on the roadside can be left out on Wednesday April 14th when Waste Management provides unlimited garbage pick up.

## Do You Need a Permit?

If you are: altering an existing building, constructing a new building, doing major repairs, adding a solar collector, adding a bay or bow window, cleaning out drainage ditches or ponds, doing any brush or tree cutting, filling or grading in a floodzone, wetland or shoreland area, you probably do need a zoning permit. For information call:

Dane County Zoning 266-4266

To view the Dane County Zoning  
Code of Ordinances visit  
their website at

[www.co.dane.wi.us/ord/dcord.htm](http://www.co.dane.wi.us/ord/dcord.htm)

In addition to a Dane County Zoning permit you may also need a Town of Dunn building permit to remodel, replace siding or windows, build, repair, or add to your home, deck or other structures. For information, call Mary at the Town Hall at 255-4219 ex 1.

## Preserving Dunn's Waterways



With all of current emphasis on comprehensive land use planning, let's not forget about "water use planning". The Town of Dunn is fortunate to have shorelines on two major lakes and a significant river system. In fact, more private shoreline is owned within the Town than in any other municipality on the entire Yahara Lakes System. Adjacent wetlands support abundant wildlife and fisheries habitats. Preserving this rich natural heritage must be ensured for future generations.

Friends of Lake Kegonsa Society (FOLKS) is a non-profit voluntary organization. FOLKS' purpose is to protect, maintain, and enhance environmental and recreational values for Lake Kegonsa and its surrounding areas. Activities intended to maintain or improve the ecology, water quality, fishing, and recreational use of the Lake/River have been undertaken during the last 15 years. Newsletters (5/yr) and email networks are designed to keep FOLKS members current on developments which affect our community.

Join the over 350 current members in supporting "water use planning" efforts in the Town by becoming a FOLKS member in 2004. Annual dues are \$10/ household, and membership is open to anyone interested. For more information, contact Ray Potempa 838-9329 or [rjp3411@aol.com](mailto:rjp3411@aol.com).

## When in Doubt Throw it Out

It only takes one wrong container in a load of 250,000 to contaminate the entire load and make it impossible to recycle. Contamination results in recyclable material being landfilled! Please follow the recycling guidelines and do your part to help maintain a clean environment!

## PROPERTY MAINTENANCE

Please note, the town receives more complaints about junk ordinance violations in the spring. Town ordinances 11.15 and 16.2 prohibit the accumulation or storage of junk outdoors. Your property should be free of unlicensed or inoperable vehicles, equipment in disrepair, dead trees, brush piles, and junk.

