

Town of Dunn
4156 County Rd B
McFarland, WI 53558

PRSR STD
U.S. Postage Paid
Madison, WI
Permit # 549



2024 Spring Newsletter

www.townofdunnwi.gov (608) 838-1081 4156 County Road B, McFarland WI 53558

Views from the Chair

By Steven Greb, Town Chair

The Sandhill crane has become the symbol of the Town of Dunn. It's our branding; you'll see it on our letterhead, new logo, and our cemetery gates. Ed Minihan, our former chair, always mused about our resident cranes and the resilience and inspiration they bring to the Town. This spring, I thought I'd do a deeper dive, learn more about their natural history, and share some of their life's story to give us a greater appreciation of this magnificent bird.

The Sandhill crane has been around a long time, with fossil records dating back at least 2.5 million years. They probably started to visit Wisconsin after the last Ice Age 12,000 years ago. There are a few notes from European settlers from the 1800's but many more observational records in the 1900's. There are actually five subspecies of Sandhill cranes, but we only have the "greater" Sandhill crane in Wisconsin.

This formidable bird is 4 ft tall and has a wingspan of 7 ft but only weighs around 10 lbs. They can live a long time (20 years) and mate for life. It takes three to five years to reach maturity before females lay their first eggs and usually raise one to two colts at a time. The colts can

grow over an inch per day!

We have a pair of cranes around our place every year and it's a joy to watch the protective parents and young offspring traverse our clover and CRP fields. You might have observed how the cranes seem to change color in the spring and summer. They coat their feathers with mud to camouflage their bodies during this vulnerable time. Most of our cranes are snowbirds, spending their summers here and winters in Florida. During migration, they can fly as high as 10,000 ft and at speeds of 60 mph.

Though we don't have population estimates going back hundreds of years, we do know that unrestricted hunting and habitat loss left the population in the 1920's at less than 100 birds in all of the US. On the verge of extinction, conservation efforts helped their recovery. The return of the Sandhill crane has been a huge success story in Wisconsin. Last year the Annual Midwest Crane Count observed 12,225 birds in Wisconsin, with over 719 here in Dane County.

So, I thought that was the happy ending to the crane story but unfortunately, not. Conservationists are now saying the victory is in jeopardy, threatened by the looming climate crisis.



Photos by A Fleeting Glimpse Photography, Kevin Cronk

The crane's migration patterns are changing. Nathaniel Miller, Director of Conservation for Audubon Great Lakes, says "birds are being pushed and tested by climate change... The climatic range of these birds has developed over millennia. It's all about timing. They're usually in the right places at the right time. In spring, they're where insects are hatching. In fall, they're where they can find nuts and berries. General warming trends, as well as extreme events like flooding, drought, and intense heat, throw this delicate balance and timing off kilter. Some birds will respond by shifting their range to the north. The danger is that habitat is slower to evolve than climate," said Miller.

Continue reading on page 2.

Arbor Day Potluck April, 27th, 2024, 4 PM to 6 PM

The Town Parks Commission will host its Annual Arbor Day Potluck at the Town Hall on Saturday, April 27th, beginning promptly at 4 PM. Bring your favorite dish to pass and enjoy your community!

After a presentation by Marie Raboin and Aaron Shottliff, a potluck dinner will be served. Brats, hotdogs, plates, napkins, utensils, and a beverage will be provided. Free trees and door prizes, while supplies last. Come meet other residents and share in this fun family event.

Marie and Aaron will discuss their work helping farmers with sustainability and improving the Lower Yahara Watershed as part of the Biological Farming Friends (BFF) watershed protection group.

Dan Oakland, a cherished Town resident, will also be receiving the 2024 Stewardship Award. From brush collection to roadside cleanup and helping at elections, this award celebrates Dan's service over many years.

Annual Town Meeting April 16th, 2024, 7:00 PM

Notice is hereby given of the Annual Town Meeting called pursuant to Wis. Stats. 60.11(1)(2) by the Town Board of the Town of Dunn, on April 16th, 2024, at 7:00 PM. Attend in-person at the Town Hall or virtually on Zoom.

Presentation of various Town reports will be presented and PDR approvals will be up for consideration. To view the meeting agenda and Zoom link, please visit dunn.civicweb.net.

2024 Extra Pick-Up Days June 13th & October 10th

Regardless of your normal service day, all extra items must curbside by 6:00 AM, THURSDAY. Only one trip through the Town will be made. If Pellitteri is unable to finish on Thursday, the event will continue into Friday. Visit pellitteri.com/pages/copy-of-clean-up-events. Contact Pellitteri with questions: (608) 257-4285.

**Views from the Chair
(Continued)**

If sandhill cranes, for example, push further north into Canada, they'll run into forests instead of finding wetlands.

I recently heard someone in the northwest corner of our Town say



Crane photos by A Fleeting Glimpse Photography, Kevin Cronk

that they saw sandhill cranes in January for the first time in their life, so they've now seen them all twelve months of the year. Maybe this observation is an indicator of climate change or portends things to come. The protection of our open spaces, natural areas, and wetland habitats have all helped support this resilient bird, but their new vulnerability should concern all of us. Of course, climate change will affect not just the crane, but many other environmental and human activities in our Town, including recreation on our lakes and crops on our agricultural lands.

The Town has and will continue to adapt to these evolving changes and strive to do our part (e.g. new solar panels at the town hall this spring) to

counter these changes and work towards a sustainable Town.

Finally, I would urge all of you to enjoy our town's open spaces. Hopefully, you'll see and hear some cranes as they announce their return with their loud ruckus calls, giving us inspiration and optimism for the future.



Voting in the Town of Dunn

2024 is a busy election year and voters may receive mailers, calls, and text messages from various groups providing messages about absentee voting, early voting, and registering to vote. We encourage all voters to use the secure government website: **MyVoteWi.gov**. The *MyVoteWi.gov* website allows online voter registration, absentee ballot requests, and provides helpful information about election dates, viewing the offices and referenda on the ballot, previous voting participation, finding where to vote, and tracking an absentee ballot's status. **In-person early voting will be offered two weeks before each election at the Town Hall, from 12 PM until 4 PM.** Questions?

Contact the Town at (608) 838-1081.

Spring Election & Presidential Primary

Early Voting Dates and Hours

Mar. 19 - Mar. 22, 12 PM to 4 PM

Mar. 25 - Mar. 29, 12 PM to 4 PM

If you are unable to vote during these times, call (608) 838-1081 for an appointment.

Polls will be open on Election Day, April 2, from 7:00 AM to 8:00 PM.



Photo by Andrea Zacharias

Stay in the Know

1. Follow us [facebook.com/townofdunndanecountywi](https://www.facebook.com/townofdunndanecountywi)
2. Sign up for meeting notifications or view upcoming/past meetings: dunn.civicweb.net.
3. Visit www.townofdunnwi.gov/announcements
4. Download the Pellitteri Waste Systems mobile app from your app store or pellitteri.com/recyclerright to set weekly trash or recycling reminders, receive real-time updates for service delays, and see your collection schedule.
5. Sign up for Rave Alert, Dane County emergency notifications about public safety emergencies in your community. To sign up, visit em.countyofdane.com/emergency-alerts.

Pellitteri Waste Systems

Accepted Paper Products

Empty cardboard, catalogs, magazines, phone books, empty food boxes, paper, envelopes, junk mail, wrapping paper (no foils), newspapers, paper cups (no plastic lids or straws), paper egg cartons, paper grocery bags, paper milk and juice cartons, pizza boxes (no food or grease), shredded paper (place in a clear or transparent plastic bag and tie shut, bag no larger than a basketball).

Accepted Plastic & Glass Products

All plastic bottles besides motor oil or gasoline bottles, #1-7 plastic items (including #1 clamshell), glass bottles and jars (clear, blue, brown, or green translucent glass).

Accepted Metal Products

Empty aerosol cans, aluminum cans or plates, metal pots and pans, metal appliances and plumbing fixtures/faucets (nothing larger than a basketball), and tin and steel cans.

Non-Recyclable Items

Batteries or propane tanks (FIRE HAZARD! Check call2recycle.org), brake rotors or drums, construction waste, electronics, frozen food or microwave dinner plates, glassware and ceramics, metal items larger than a basketball or heavier than 10lbs, mirrors, windows, motor oil and gasoline containers, plastic film or wrap, styrofoam, recyclable containers containing liquids or food, carpet, clothing, diapers, fishing line, food, hoses, ropes, and shoes.

Recycling Tips

- Stop "wishcycling" and download the Pellitteri Waste Systems Mobile App to use the Recycle Right search to dispose of specific items properly.
- Additional recyclables outside of recycling carts must be prepaid for and prescheduled for pick-up. Contact Pellitteri a minimum one day prior to your normal service day. Additional recyclables must be in clear plastic bag (s) next to the recycling cart, no larger

than 32 gal., and no heavier than 50 lbs. Cut down cardboard to fit in bags, do NOT bundle or place in a bigger box.

- Only flatten/crush cardboard boxes, NO plastic or metal items.
- Don't place smaller items inside larger ones. Items should be loose and empty.
- Remove all food waste, plastic, Styrofoam, and packing peanuts. Containers containing food or liquids, construction waste, or electronics CANNOT be recycled.
- Recycling carts will not be picked up if it contains trash, yard waste, prohibited items, or if overloaded.
- In a week containing certain observed Holidays, pick up is delayed by one day. Check with Pellitteri for a schedule.
- For additional pick-up volume or for questions, contact info@pellitteri.com or call (608) 257-4285.

Electronic Recycling

TVs, laptops, cellphones, and other electronics contain valuable materials that can be recovered through recycling. Electronics also contain hazardous materials which can harm human health and pollute the environment if not properly managed. Wisconsin has a electronics recycling law which prohibits the following electronics from being put in the trash or sent to Wisconsin landfills and incinerators:

TVs, computers, printers, scanners, fax machines, monitors, computer accessories such as keyboards, mice, speakers, external hard drives, flash drives, e-readers, VCRs/DVD players, and cellphones.

These electronics can be recycled at various locations across the state. For a list of collection sites, visit dnr.wi.gov and search "ecycle".

Some collectors may charge fees and may not accept all devices. Contact collectors beforehand to learn about their policies. Please direct additional questions to Wisconsin DNR ECycle at (608) 264-6001.

Town Transfer Site

Open to Town residents only. Located at 4030 County Road B, 1/4 mile east of the Town Hall. Open monthly on the 1st and 3rd Saturdays from 8 AM to 4 PM, exceptions may be on Holidays or Holiday weekends. April through the end of November, the Transfer Site is also open Wednesdays from 2 PM to 4:45 PM.

Accepted Items

Brush and wood free of soil, leaves and grass clippings, any compostable material, holiday trees without tinsel, decorations, or stands, antifreeze that is free of oil, motor oil that is free of other liquids, automotive type and rechargeable batteries, all appliances (except water softeners and dishwashers), scrap metal, and motors free of gas and oil.

Tires are also accepted for a fee. Fees are based on our costs for disposal. At the time of this publication, auto tires without rims are \$5 and \$10 for tires with rims. Fees for semi-truck tires are \$10 and tractor tires are \$25.

Non-Accepted Items

Construction materials, dishwashers, electronics, furniture, mattresses, household batteries, lumber, shingles, stumps, TVs, and water softeners.

Dane County Clean Sweep

7102 US Hwy 12, Madison, WI 53718. Dane County Clean Sweep offers a place to bring hazardous household materials and electronics. For a list of acceptable items, visit danecountycleansweep.com. Fees apply. Prior to delivering items or for current hours, contact Clean Sweep at (608) 838-3212.

Medication Drop Off

Protect our water resources! Do not flush medications down the drain. Drop off unwanted or expired medication at local police departments:

- McFarland: (608) 838-3115
- Oregon: (608) 835-3111
- Stoughton: (608) 873-3374

Upcoming Highway 51 Construction (2024-2027)

In the coming years, major reconstruction work will take place on US Highway 51 between Stoughton and McFarland. Medians will be added, roundabouts with new signs and lights will be incorporated at certain intersections, and parts of the road will be closed to thru traffic. In the end, the project will improve safety along this approximately 5.6 mile section of road.

The first step will occur this season when a roundabout is built at the US 51/HWY B/HWY AB intersection.

2024 Tentative Construction Plan:

Stage 1: Placement of temporary pavement on the east side of US 51. No anticipated traffic impacts.

Stage 2: Shift US 51 lanes east and

construct the west side of the roundabout. HWY B (west) is closed. HWY AB is open to right in/right out traffic only.

Stage 3: Shift US 51 lanes west and construct the east side of the roundabout. HWY B (west) is open to right in/right out traffic only. HWY AB is closed (driveways access provided within construction zone).

Stage 4: US 51 closure. HWY B (west) and HWY AB are open to local traffic. Detour for US 51 traffic provided via WIS 138, US 14, and US 12/18.

This project is being overseen by the Wisconsin Department of Transportation (WisDOT). For more information contact Kevin Drunasky at kevin.drunasky@dot.wi.gov.



Photo of the proposed roundabout at the intersection of HWY 51/HWY B/HWY AB by WisDOT

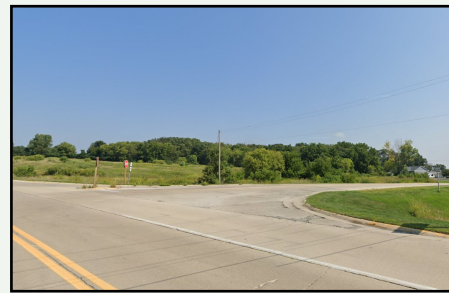

Photo of US 51 and HWY B/AB intersection from Google Maps street view

There are also plans to replace two culverts on Lalor Rd at Murphy's Creek. We appreciate your patience for any inconveniences while we work to maintain Town roads.

Roadside Mowing

In response to more invasive plants taking hold along our roadsides and in an effort to deplete viable seed production of these plants, we may mow more often and/or the full road right-of-way (RROW) width. Keep all obstacles, including **any** signage, out of the RROW, which is typically 33-feet from the center of the road.

Mailbox and Garbage Cart Placement

To facilitate RROW maintenance and improve traffic and mail carrier safety, mailboxes must be installed or repaired in accordance with the Town's Mailbox Policy. Visit www.townofdunnwi.gov/policies to view the policy.

Place garbage carts in your driveway apron and NOT in the road to help with motoring safety, collection or plowing efforts, and to prevent tipped over carts. Keep carts at least four feet away from each other and away from any other obstacles. Improperly placed carts makes it difficult for garbage trucks or snowplows to perform their jobs.

On the Road Again...

By Todd Klahn, Highway Foreman

In 2023, the following roads received a 2-inch overlay: Brian St, Bruce Pkwy, Maple Dr, Maya Ct, Oak St, Orchard St, Scott Ln, and Thomas Ln. Due to the 2-inch increase in overall road height, all mailboxes in this area **must** be brought into compliance with the Town's Mailbox Policy. Visit www.townofdunnwi.gov/policies to view the policy. Contact the Town with any questions.

2024 Road Work

Town paving projects are currently under review while we await confirmation if significant grant funding has been approved. Notification of grant awards is anticipated around early April. Check www.townofdunnwi.gov/announcements for future updates, including project locations and construction timelines.

Sealcoating is planned for the following roads: Bonner Trl, Holm Rd, Hook Island Rd, Labrador Rd, part of Lake Kegonsa Rd, Rutland-Dunn Townline Rd, Sand Hill Rd (south of Townline), and Schuster Rd (Dunn's section). This list is tentative and may change based on bids received.

Firearm Discharge Ordinance Introduced

By Cathy Hasslinger, Clerk/Treasurer

Hunting and target practice are popular activities in the Town and there are concerns when these activities occur close to homes. A proposed Town ordinance regulating the discharge of firearms has the potential to improve these activities for both hunters and nearby residents. One restriction in the proposed ordinance is prohibiting shooting within 400-feet of a home unless the individual has permission from the residents of nearby homes. This would be a 100-foot increase from the 300-foot buffer currently provided by state law and would benefit nearby residents. The primary benefit of a local ordinance would be that the penalty for violating the proposed ordinance

is a citation with a fine, whereas currently, wardens and deputies can only issue a criminal charge for state law violations. Therefore, a Town Ordinance would benefit individuals by allowing enforcement with a fine, and without saddling any offenders with a criminal charge. View the proposed ordinance at www.townofdunnwi.gov/ordinances.



Photo by A Fleeting Glimpse Photography, Kevin Cronk

2024 Busy Year for Lake Waubesa Conservation Association

By George Keeler and Joan Behr, LWCA

2024 promises to be even busier than the last few years for Lake Waubesa Conservation Association (LWCA). The first Lake Management Plan (LMP) for Lake Waubesa is scheduled to be completed in the fall of 2024 and will identify and prioritize projects to systematically improve the quality of the lake. Details on development status of the plan, goals, schedule, opinion survey, and shoreline survey results can be found at www.waubesa.org/Imp. Additional data collection and analysis are planned which will complete the foundation for the LMP. Then, the LMP must be finalized so that implementation can begin by 2025.

Volunteer Involvement Will be Key to LMP Implementation:

Community involvement is a key goal for the success of the LMP. Volunteers will be needed and interested parties are encouraged to contact Tamara Knickmeier,

LWCA's president, at waubesa.org@gmail.com, about how their skills and interests could make a difference with improving the lake. Also, check out the "What can I do?" page on LWCA's website. **Shoreline and Roadside Clean-up; Pier Pick-up Program:** LWCA and the Waubesa Beach Neighborhood Association need volunteers to help this spring with roadside and shoreline clean-up. This is a great way for individuals and families to spend a couple of hours beautifying our Town. Roadside clean-up will take place during Earth Week which is April 22-26. Sign-up info and the date for shoreline clean-up will be announced soon at www.waubesa.org/events and www.facebook.com/Waubesa.

LWCA is also partnering again with Dane County to have a shoreline barge crew pick up aquatic plants and debris from residents' piers during the late spring and summer

months. Details and schedule will be available at www.waubesa.org/events.

LWCA's strong commitment to 'promoting the preservation, protection, and enhancement of the Lake Waubesa ecosystem for all to enjoy' depends on dedicated volunteers, members, sponsors, and partners. Participation and support from Dunn residents is essential for developing and executing a lake management plan that will 'advance the well-being of Lake Waubesa.'



LWCA President Tamara Knickmeier, right, presents a \$1,000 check to the Clean Lakes Alliance to help support the lake monitoring program.

Residents Encouraged to Participate in Private Well Testing for PFAS

PFAS have been detected in some wells (about 1/3 of those tested) in the Waubesa Beach Neighborhood. As a result Public Health Madison & Dane County (PHMDC) is providing FREE well testing for income eligible households. Households not eligible for free testing are eligible for discounted testing. Typically, a well test for PFAS is around \$600, but at this time, the rate is \$418.

What are PFAS? PFAS human-made chemicals known as “forever chemicals” because they do not break down easily. They’ve been used for over 50 years and are now common in our environment.

Where do PFAS come from? PFAS are in a lot of everyday products



Photo of healthy Oak tree from Creative Commons

Town of Dunn Fall Event

Sat., Oct. 12, 9 AM to 11 AM

Mark your calendars for the Town’s Fall Event at the Town Hall! There will be donuts, coffee (milk and juice for kids), and small bare-root trees, while supplies last. Start your morning off by chatting with neighbors over coffee and donuts and then take a tree to go!

because they’re durable and resist water, grease, fire, heat, and oil. This means they can be used in products used to prepare or eat foods, like non-stick cookware, fast food wrappers, and microwave popcorn bags. They’re also used in products like rain gear, stain proof or resistant carpets, and even makeup.

Why test my well? PFAS can accumulate in your body over time so it’s important to limit exposure to protect health. Testing is the only way to know if you need to install a drinking water filter rated effective for removing PFAS. When shopping for filters, check labels for ANSI/NSF Standard 53. For Reverse Osmosis systems, look for ANSI/NSF Standard 58.

How do I get my well tested for PFAS? Income eligibility guidelines

Oak Tree Pruning Prohibited April 1st - October 15th

In an effort to control the spread of Oak Wilt, Ordinance 20-03, prohibits the pruning, cutting, or other wounding of Oak trees from April 1st to October 15th of any year without permission from the Tree Board. Ongoing research may cause amendments to the restriction dates. If wounding occurs or pruning is necessary during the restriction period, a tree wound dressing shall be applied immediately to each wound. The cut surface of stumps from living, non-infected Oak trees shall be immediately painted with a wound dressing. visit www.townofdunnwi.gov/ordinances to view the full ordinance.

for free testing is based on 2022 income taxes and must be met to receive free testing. Guidelines - Total People in Household: 1 = \$66,300, 2 = \$75,750, 3 = \$85,200, 4 = \$94,640, 5 = \$102,250. For large family income guidelines or to retrieve a testing application, visit publichealthmdc.com/ and search “PFAS”. Free testing is available while funding lasts, or through June 2024, so don’t delay!

Households exceeding income limits for free testing can email lab@publichealthmdc.com to order a sample kit. Include your name, address, and contact info.

Where can I get more information? Contact PHMDC at (608) 266-4821, health@publichealthmdc.com, or visit publichealthmdc.com.



Photo of diseased Oak tree, indicating Oak Wilt, from Creative Commons

Open Book

Contact the Assessor now by phone or email with questions or concerns about property tax assessments. Associated Appraisal Consultants: (920) 749-1995 or info@apraz.com. If questions remain, call the Assessor for an Open Book appointment on Tuesday, May 7th, between 4 PM to 6 PM.



Photo at Grass Lake by Mary Liebig

A Beautiful Way to Reduce Stormwater Runoff

Information from Wi DNR

Rain gardens, which are small, shallow areas filled with native plants, capture 30% more water than regular lawns and filter water into the ground. This reduces the amount of water containing fertilizers, pesticides, oils, and other contaminants from entering our waters. Planting a rain garden is a great way to help protect our lakes and streams. Rain gardens are also a delight to view and a nice place for birds and butterflies to live. For a “How to Build a Rain Garden” manual, visit www.raingardennetwork.com.

Town of Dunn Parks Update

In 2023, invasive species removal and prairie restoration continued at Dunn Heritage Park. Thanks to a Dane County grant, the Town has plans to restore areas in this park that were damaged by flooding. Unfortunately, our parks crew was unable to dredge over the winter because the ground never froze. We hope to complete this project next year. Over the next few years, select boardwalk installations and tree plantings will also occur. These activities should help make this park

Last Chance to Receive USDA Funding for PDR Program

The U.S. Department of Agriculture (USDA) allotted just over 1 million dollars in federal funding for Dunn landowners interested in participating in the Town’s Purchase of Development Rights (PDR) program to preserve their farmland. This program protects working lands to support the local agricultural economy and to assure the future availability farmland. Through PDR, potential residential “development rights” are purchased by the Town and are permanently eliminated through a conservation easement. So far, 39 properties, totaling almost 4,000 acres have been protected through the Town’s PDR program. **Funding under this grant program is expiring at the end of this year.** If you have any interest in enrolling your land in the PDR program, now is the time to start a discussion. Contact Ben Kollenbroich by March 31st at (608) 838-1081, ext. 3, or bkollenbroich@townofdunnwi.gov.

Keep Invasive Plants Out Of Spring Garden Plans

By Erika Segerson-Mueller, DNR Invasive Plant Program Specialist

With spring on the way in Wisconsin, many gardeners are dreaming of spring blooms and designing the next garden or landscape layout. Before purchasing, it’s essential to check your selections and choose native plants when possible. Many invasive plants that are problematic for Wisconsin forests started as garden ornamentals. Native wildflower seed mixes can be especially problematic because they are often mixed with invasive seeds, so carefully read the label before buying. If you aren’t sure if a plant is invasive, try searching the name along with “invasive” and “Wisconsin” to verify. Invasive plants can quickly spread and take over an area, crowding out other plants and creating a monoculture (an area dominated by a single plant). This can reduce biodiversity and increase fire risk. Native plants are adapted to the local climate and soil and will attract beneficial insects and pollinators.

more accessible, improve fish spawning habitat of the ponds, and better capture stormwater runoff from nearby properties.

The Town also planted native seed in part of Simpson Park to transform roughly an acre into a prairie and walking area.

Spring prescribed burns are planned in naturalized areas in Town parks.

Be sure to get out and enjoy our parks! Please make sure to keep pets leashed and to clean up after them

and dispose of waste properly. Park locations can be found at townofdunnwi.gov/parks.



Photo taken at Dunn Heritage Park by Mary Liebig